



414-778-5800



Sales@beyondVision.com



www.BeyondVision.com



5316 W. State Street

Milwaukee, WI 53208

## Corner Desktop Sit-Stand Workstation



**NSN 7110-01-692-5299**

### Features & Benefits

- Turns L-shaped desk into a corner stand-up desk
- Easily fit a laptop, dual-monitors, keyboard, and accessories up to 35-pounds
- Smoothly transition between a variety of height settings
- Keyboard surface with 20-degree adjustable tilt
- Pre-assembled



Help employees avoid the detrimental health effects associated with sitting for extended periods of time with this corner unit, two-tiered, adjustable-height standing desk designed to accommodate dual-monitors. Workstation can be placed atop any desk or table and raised to a standing position or lowered to a sitting position. Desktop workstation constructed of wood and steel is 42 inches wide and has a 35-pound capacity. Fully extended height is 20". TAA and Berry Compliant; assembled in the USA.



Produced by Beyond Vision, Inc., Milwaukee, WI.

Fulfills the required source provision of the Javits-Wagner-O'Day Act and FAR 8.7.

SKILCRAFT® is a registered trademark owned and licensed by National Industries for the Blind, an AbilityOne® Authorized Enterprise.



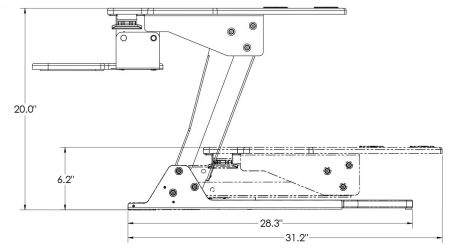
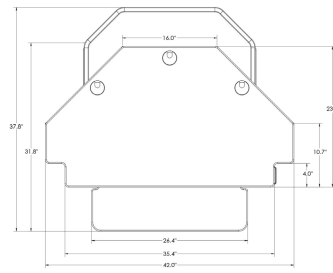

# Corner Desktop Sit-Stand Workstation

NSN	eCommerce Product Name				
7110-01-692-5299	Corner Desktop Sit-Stand Workstation				
Product Details					
Color	Size	Type	U/I	MOQ	
Black	42" wide, 35-pound capacity	Corner Unit	EA	1	
Shipping Information					
Packaged Height	Packaged Width	Packaged Length/Depth	Packaged Weight	Quantity Per U/I	UPC
9	36	46	54	1	806229508033
Master Carton Height	Master Carton Width	Master Carton Length/Depth	Master Carton Weight	Master Carton Units	Master UCC
9	36	46	54	1	100806229508033
Pallet Height	Pallet Width	Pallet Length/Depth	Pallet Weight	Pallet Units	Harmonized Tarriff Code (HTC)
48	40	48	1000	4	

## SKILCRAFT® Corner Desktop Sit-Stand Workstation:

<b>Fully Assembled</b>	No tools required, simply place on desk
<b>Weighs 42lbs.</b>	Allows for easy installation and moving from desk-to-desk
<b>Fits 90° Corner Desk</b>	Maximize functionality of traditional workspace in the desk corner
<b>Gas Assisted Height Adjustment</b>	Smooth, quiet and infinite adjustment possibilities, extending up to 20" above desk surface
<b>Keyboard Tilt</b>	-10°/+10° of infinite ergonomic possibilities
<b>Large Work Surface</b>	Accommodates 2 x 24" monitors, laptop or laptop with monitor
<b>Keyboard Surface</b>	Superior ergonomics compared to single work surface units
<b>Supports 35lbs.</b>	Strong enough to support user's technology requirements
<b>Organized</b>	Three built in grommet holes for cable and cord management



**For Detailed Product Information:**  
 Scott Hegle  
 Beyond Vision  
 Government Sales Specialist  
 (414) 455-6737  
 shegla@beyondvision.com



**To Place an Order**  
 Stacy Fuehrer  
 Beyond Vision  
 Customer Service Representative  
 (414) 778-5800  
 sfuehrer@beyondvision.com

